

WIRE LIST												
LEAD DESCRIPTION	PAIR	P2 (DB15)	REFERENCE - SCSI 68 PIN	SIGNAL - ARINC-429 32CH.	SIGNAL NAME - IX	COND.	COLOR	P1	P2	P3	P4	P5
TRIG, IRIG	0	1	62	TRIGGER OUT	B	C32	RED	2				
		7	28	GND	I (REF)	C33	WHITE	3				
	1	7	28	GND	CHSGND	SHIELD_16	SHIELD/DRAIN	SHELL				
		15	63	IRIG-OUT	C	C34	BROWN	4				
		7	28	GND	I (REF)	C35	WHITE	3				
		7	28	GND	CHSGND	SHIELD_17	SHIELD/DRAIN	SHELL				
	2	8	29	IRIG-IN	F	C36	ORANGE	7				
		7	28	GND	I (REF)	C37	WHITE	3				
	3	7	28	GND	CHSGND	SHIELD_18	SHIELD/DRAIN	SHELL				
				NC	NC							
		7	28	GND	CHSGND	SHIELD_19	SHIELD/DRAIN	SHELL				
	N/A		SHELL	SHELL	CHSGND	OUTER SHIELD	SHIELD/DRAIN	SHELL				

TABLE 1	
LENGTH	TOLERANCE
<2M	+5CM/-0CM
2 TO 5M	+10CM/-0CM
>5M	+15CM/-0CM

CONNECTORS AND HARDWARE <sup>2</sup>	
REF DES/ITEM	DESCRIPTION
P1	HIROSE IX INDUSTRIAL (OR OTHER IEC 61076-3-124) CONNECTOR, FEMALE, TYPE B
P2	15-POSITION HIGH-DENSITY DSUB, MALE
6	OVERMOLD FOR DB15

CABLE DETAILS				
ITEM	CONSTRUCTION	CONDUCTORS	INSULATION	JACKET
2	4 SHIELDED TWISTED PAIRS, WITH OVERALL SHIELD	30 AWG TINNED STRANDED COPPER (7/0.10MM, 0.30MM OD)	0.15MM THICK SRPVC, 0.6MM OD	0.76MM THICK PVC, 5.50MM OD

<sup>2</sup> PRODUCT AND COMPANY NAMES MENTIONED ARE TRADEMARKS OR TRADE NAMES OF THEIR RESPECTIVE COMPANIES.

1. REFER TO PRODUCT MANUAL ON NI.COM FOR MORE DETAILS.

NOTES: UNLESS OTHERWISE SPECIFIED.

METRIC

CUSTOMER DRAWING

UNLESS OTHERWISE SPECIFIED DIMENSIONS ARE IN MILLIMETERS AND [INCHES]  
DO NOT SCALE DRAWING  
THIRD ANGLE PROJECTION

NI.COM  
AUSTIN, TEXAS

TITLE  
SHDB15M-IXBF ARINC TRIG

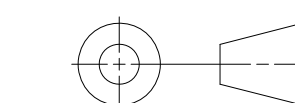

SIZE CODE IDENT NO. MM/DD/YYYY  
D 7U296 08/22/2023  
SCALE: 1/1 SHEET 1 OF 2