

ISOMETRIC VIEW

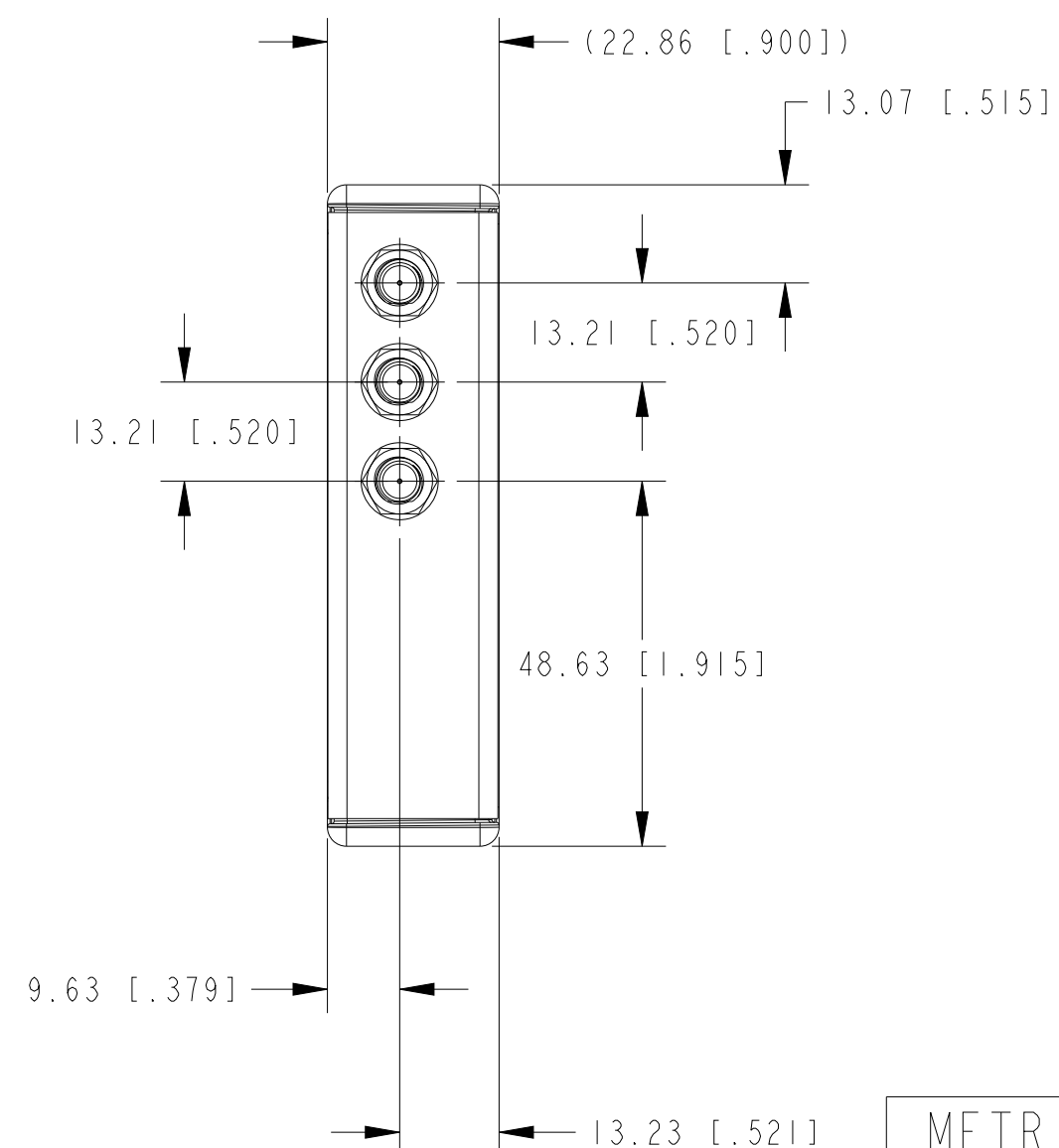
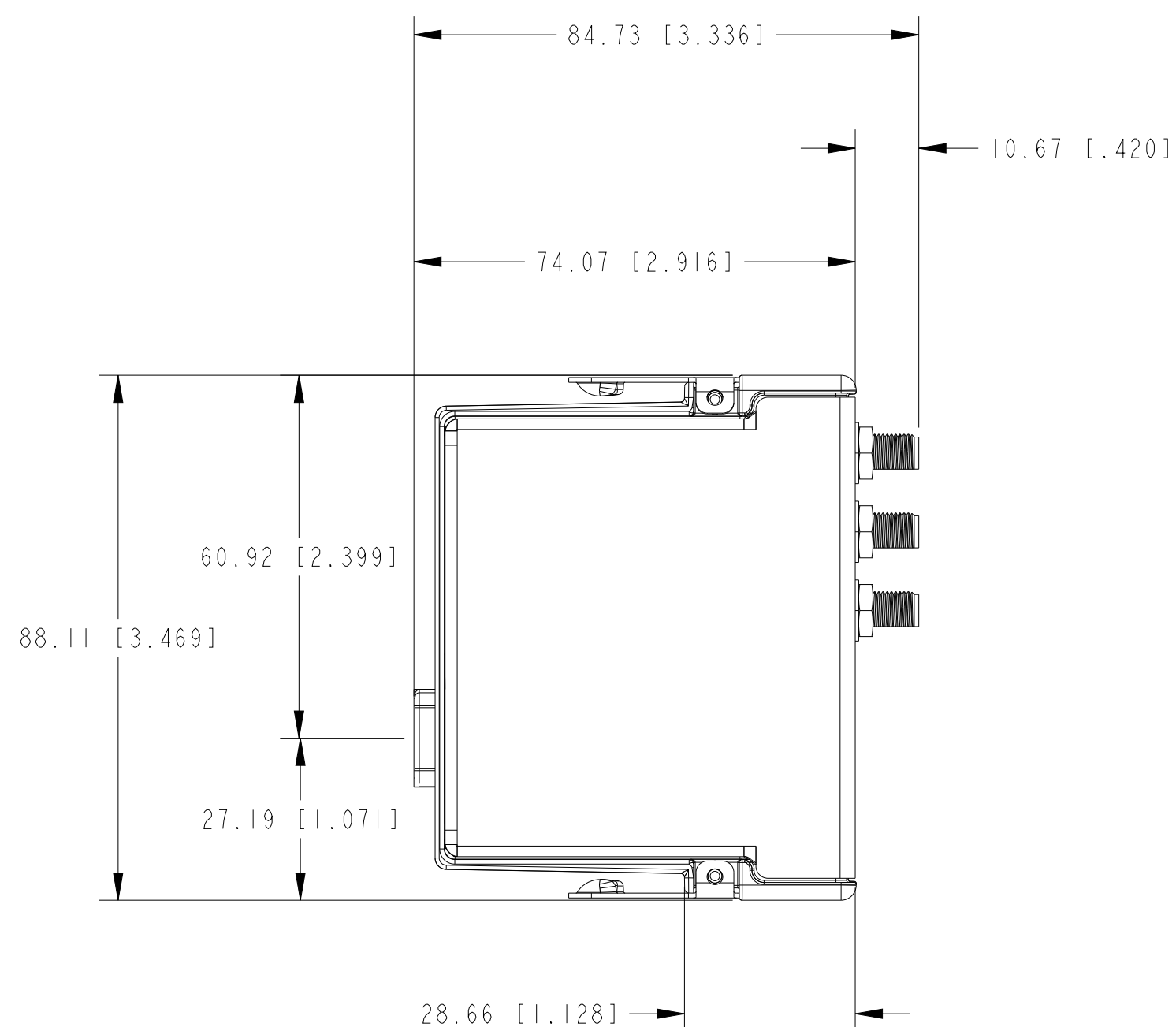

METRIC

CUSTOMER DRAWING

2. DIMENSIONS IN ( ) ARE FOR REFERENCE ONLY.  
 1. REFER TO PRODUCT MANUAL ON NI.COM FOR MORE DETAILS  
 NOTES: UNLESS OTHERWISE SPECIFIED.

UNLESS OTHERWISE SPECIFIED  
 DIMENSIONS ARE IN MILLIMETERS  
 AND [INCHES]

DO NOT SCALE DRAWING

THIRD ANGLE PROJECTION

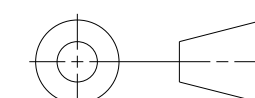

**NATIONAL INSTRUMENTS®** AUSTIN, TEXAS

TITLE

NI 9770

SIZE CODE IDENT NO. MM/DD/YYYY  
 C7U296 01/11/2019

SCALE: 1/1 SHEET 1 OF 1